

SURFACE MOUNT RF COAXIAL CONNECTORS

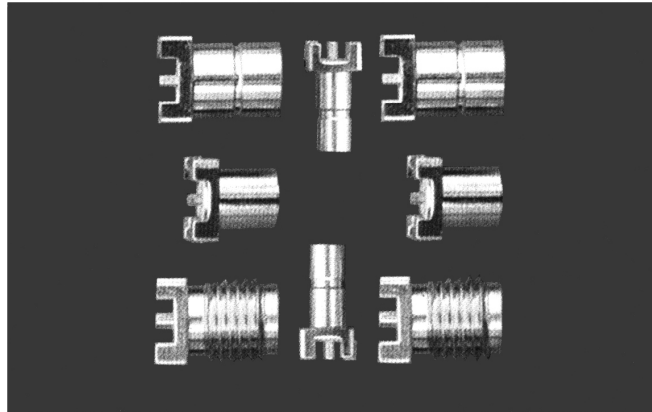

Surface mount connectors are attached to the circuit board by soldering but not in the same fashion as the through hole mount of the PCB connector. These units are attached to pads on the board by means of a solder reflow process. This eliminates the need for drilled holes and reduces the overall installation. CERNEC offers surface mount connectors in series SMA, SMB, SMC, MCX, SSMB, and MMCX.

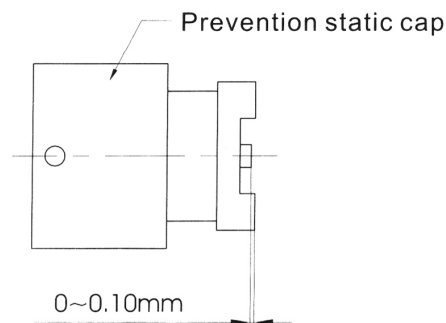
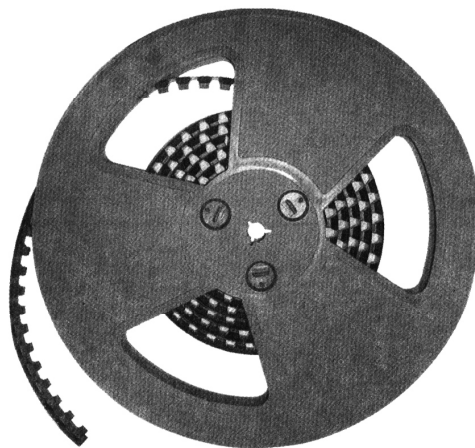

SURFACE MOUNT SERIES

CERNEX, Inc.

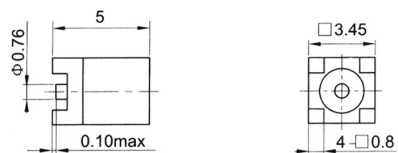

Type	part number	Note
------	-------------	------

MMCX-KHT	1520-4801	
----------	-----------	--

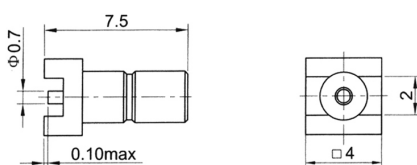
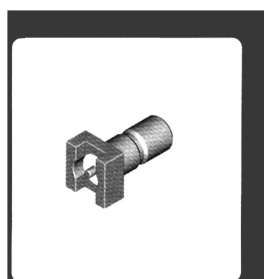

Type	part number	Note
------	-------------	------

SSMB-JHT	1010-4801	
----------	-----------	--

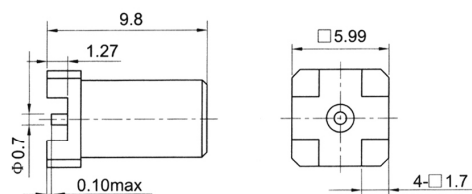
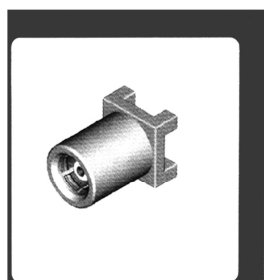

Type	part number	Note
------	-------------	------

SSMB-KHT	1020-4801	
----------	-----------	--

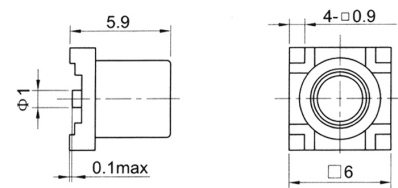
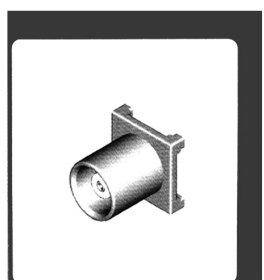

Type	part number	Note
------	-------------	------

MCX-KHT	0020-4801	
---------	-----------	--

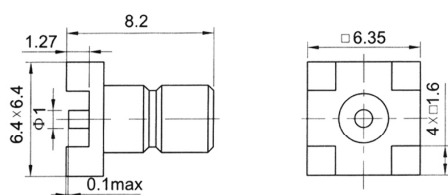
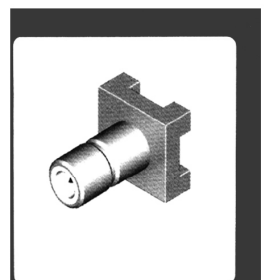

Type	part number	Note
------	-------------	------

SMB-JHT	0410-4801	
---------	-----------	--

SURFACE MOUNT SERIES

CERNEX, Inc.

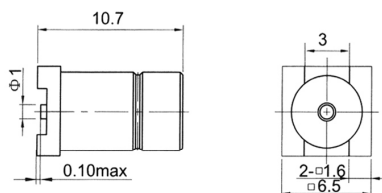
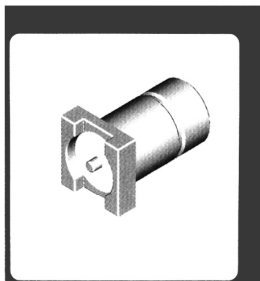

Type	part number	Note
------	-------------	------

SMA-KWHT	0340-4801	
----------	-----------	--

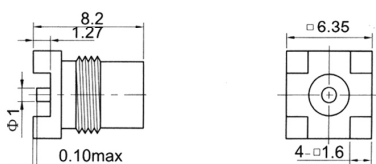
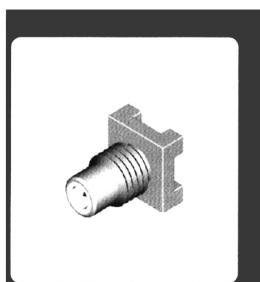

Type	part number	Note
------	-------------	------

SMC-JHT	0510-4801	
---------	-----------	--

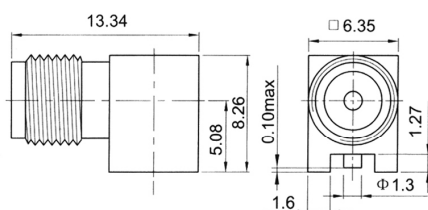
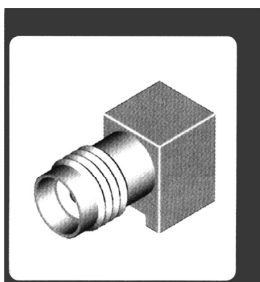

Type	part number	Note
------	-------------	------

SMA-JHT	0340-4801	
---------	-----------	--