

SERIES DS RF COAXIAL CONNECTORS

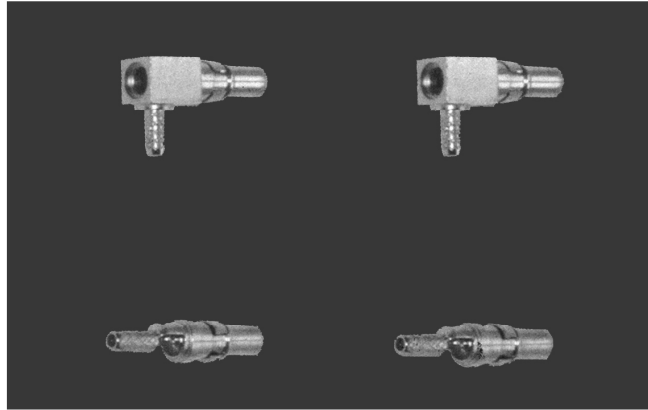

DS series is used as a contact in the D-Sub series of multi-pin connectors when it is necessary to run DC and RF signals through the same junction.

Key performance

Characteristic Impedance : 50Ω

Frequency range : 0~1GHz

Contact resistance :

Center conductor $\leq 6.0m \Omega$

Out conductor $\leq 2.0m \Omega$

Insulation resistance : $\geq 500M \Omega$

Insulator voltage withstanding : 500V

VSWR : ≤ 1.30

Connector durability : 500 cycles

Applicable spec/std : MIL-C-24308

Material

Center contacts:

Male---brass, gold plated.

Female---beryllium copper, gold plated

Bodies and other metal parts:

brass, gold plated

Insulators: Teflon

Crimp ferrule: copper, nickel plated.

Gasket and seal rings: silicone rubber

Heat-shrink tubing: thermofit plastic.

Interface Dimensions

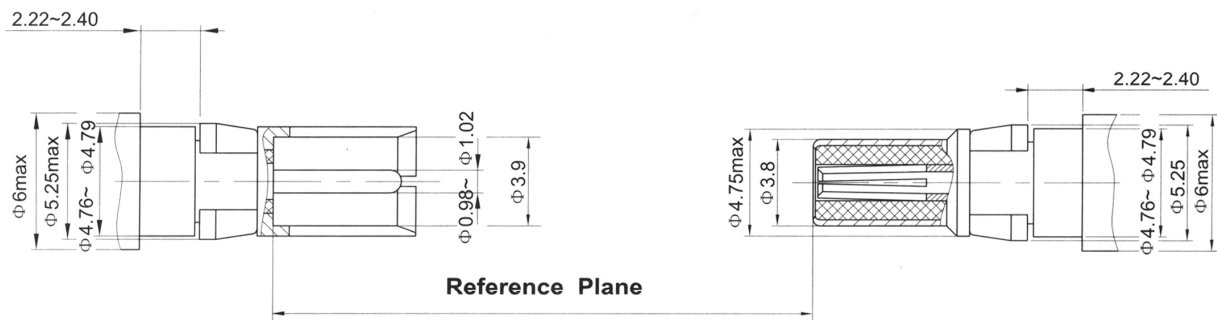

DS SERIES

CERNEX, Inc.

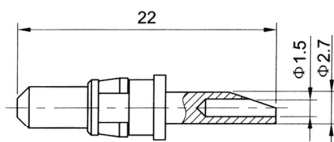
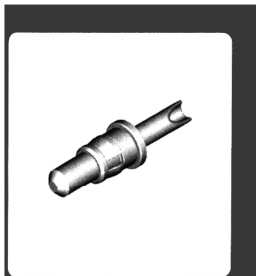

Type	part number	Note
DS-JY	1310-6900	high-voltaic plug

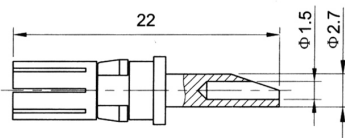
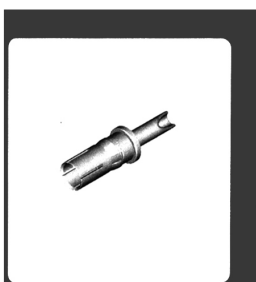

Type	part number	Note
DS-KY	1320-6900	high-voltaic jack